

# NEMO STUDIO

Commercial Project Lookbook

**Nemo Studio by Ilti Luce** (formerly known as “Ilti Luce”) is a lighting manufacturer based in Turin specializing in **bespoke accent lighting** for retail, museum and residential sectors.

Our clients include:

- Armani (Milan)
- Philipp Plein (Milan)
- Juventus FC (Milan)
- FC Barcelona (Barcelona)
- Sivasdescalzo (Barcelona)
- Valextra (Beijing)
- Poltrona Frau (New York, Los Angeles)
- Poliform (Milan, London)
- Louvre Museum (Paris)
- Chateau Versailles (Versailles)
- Cassina (London, Paris, Milan)
- Fratelli Rossetti (Milano)
- Aspesi (Madrid, Verona)



# THE MINIFLUX COLLECTION

Linear Accent Lighting modular LED system for indoor & outdoor



## MINIFLUX TRANSPARENT



- 1m/ 2m/ 3m
- 2700K/ 3000K/ 4000K/ 6000K
- RGB/ RGBW/ TW
- 16W (HP) - 20W (HP Plus)
- CRI >80/ CRI >97
- IP65
- Dimmable (1-10V, DALI, DMX, Casambi)
- Customisable lengths

## MINIFLUX OPAL



- 1m/ 2m
- 3000K/ 4000K
- RGB
- 905lm/m
- CRI >97/ CRI >94
- IP65
- Dimmable (1-10V, DALI, DMX, Casambi)
- Customisable lengths





MINIFLUX OPAL





ARMANI / SILOS









MINIFLUX TRANSPARENT





















## RIGA OPAL



- 15 x 15 x max5030mm
- FL, SL, OPAL
- 2800K/4300K
- 9,6W/m ( 3D – 8W/m)
- CRI >80
- PVC and opal resin
- IP67 (FL, SL) IP68 (OPAL)
- Dimmable (1-10V, DALI, DMX, Casambi)

## RIGA TRANSPARENT



- 1m/ 2m/ 3m/ 4m/ 5m
- 1,5x0,7x100mm
- 2700K
- 1400lm/m
- CRI >85
- Transparent resin
- IP68
- Dimmable (1-10V, DALI, DMX, Casambi)
- Customisable: lengths, CCT & voltage



RIGA OPAL







RIGA TRANSPARENT





# THE SPOTLIGHT COLLECTION

Minimalistic Design, Maximum Performance

## VULCANO



- CCT: 3000K
- CRI>90
- 13W
- Flux: 900 lm
- Optic: 30°
- Integrated driver
- On-off
- Finishes: black, white
- Dimensions: Ø5,6x16cm

## ELBA



- CCT: 2700K/ 3000K
- CRI>90
- 13W
- Flux: 900lm
- Optic Zoom: da 15° a 55°
- Integrated driver
- Triac or 1-10V
- Finishes: black, white
- Dimensions : Ø5,6x15cm

## CAPRI



- CCT: 2700K/ 3000K
- CRI>90
- 28W
- Flux: 1500lm
- Optic Zoom: da 15° a 55°
- Integrated driver
- Triac or 1-10V o DALI
- Finishes: black, white
- Dimensions : Ø7,3x17cm











## FLEX TRACK



- Track - 1,2,3m
- 3000K/ 4000K
- 5W
- Fixed optic & Zoom optic spot
- Anodized black aluminium
- IP20
- Dimmable (1-10V, DALI, DMX, Casambi)









## SHARP ZOOM



- 2700K/ 3000K/ 4000K
- 380 lm (7°) - 1560 lm (55°)
- CRI > 94+
- Black, white
- IP20
- Dimmable (Onboard Dimming 3%-100%, DALI, On-Off, Casambi)
- Customisable: CRI , lumen flux, finishing, driver box



reddot design award  
winner 2019

## SHARP FRAME

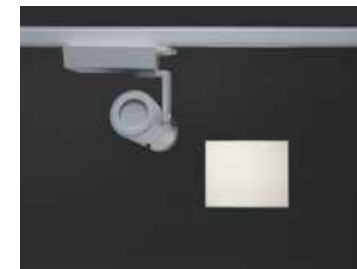

- 2700K/ 3000K/ 4000K
- 920 lm
- CRI > 94+
- Black, white
- IP20
- Dimmable (Onboard Dimming 3%-100%, DALI, On-Off, Casambi)
- Customisable: CRI, lumen flux, finishing, driver box



reddot design award  
winner 2019













# The Zirkol Family





*Zirkol C*



*Zirkol O*

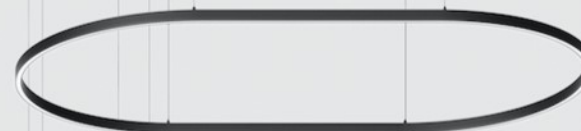

*Zirkol S*



# Technical Characteristics

- Aluminium 6060 T5 extruded profile
- Homogeneous light distribution: **opal screen**
- Direct only or with indirect light emission
- CRI 90
- Three **finishings** available: *matt white, matt black and matt gold*

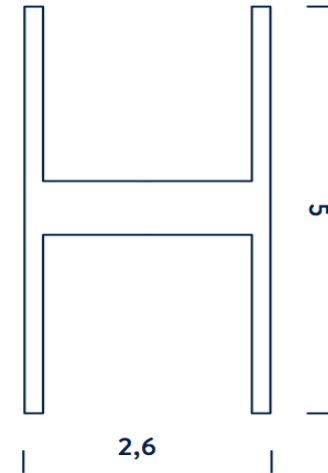

Matt Black



Matt White



Matt Gold



\*Specific RAL/FINISHING on request



reddot winner 2020



# Configurations



## Emission



Diffused Downlight

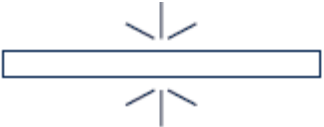

Diffused Downlight + Uplight

## Dimming



1%



Fine DALI /  
push button regulation 1-100%



100%

## CCT



2700K



3000K



4000K

## Other light configurations



Tunable white



RGB



RGBW



ZIRKOL Linear



ZIRKOL C











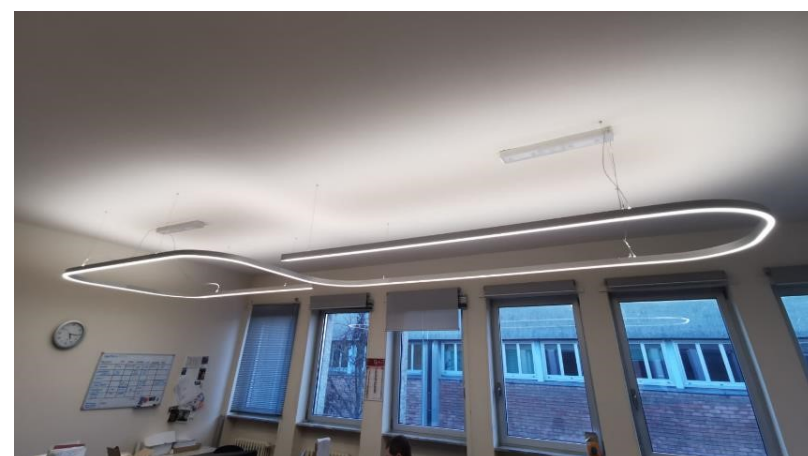

Our products are easily-customisable to adapt to the individual prerequisites

**Bespoke customization of Shapes, Colours and Functionality**













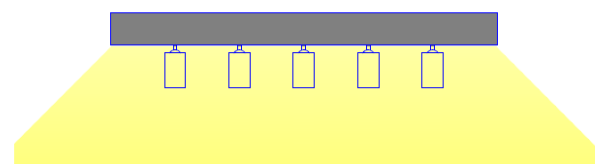
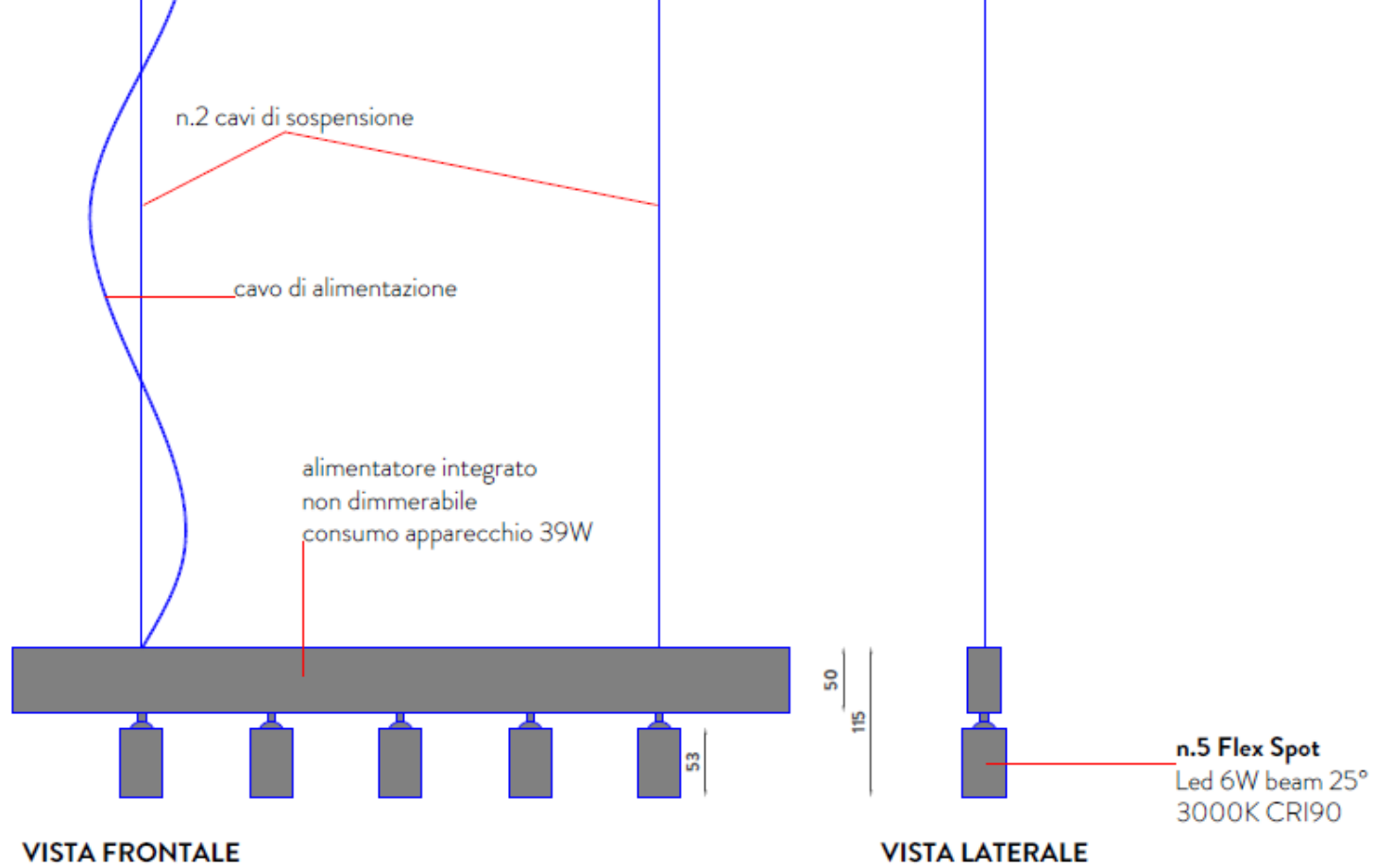

Luce diffusa\*

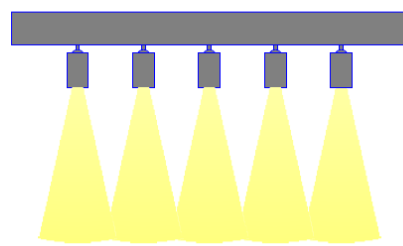

Luce puntuale\*







P04, P15 LINEAR PROFILES  
CUSTOMIZED SOLUTION

# NEMO STUDIO

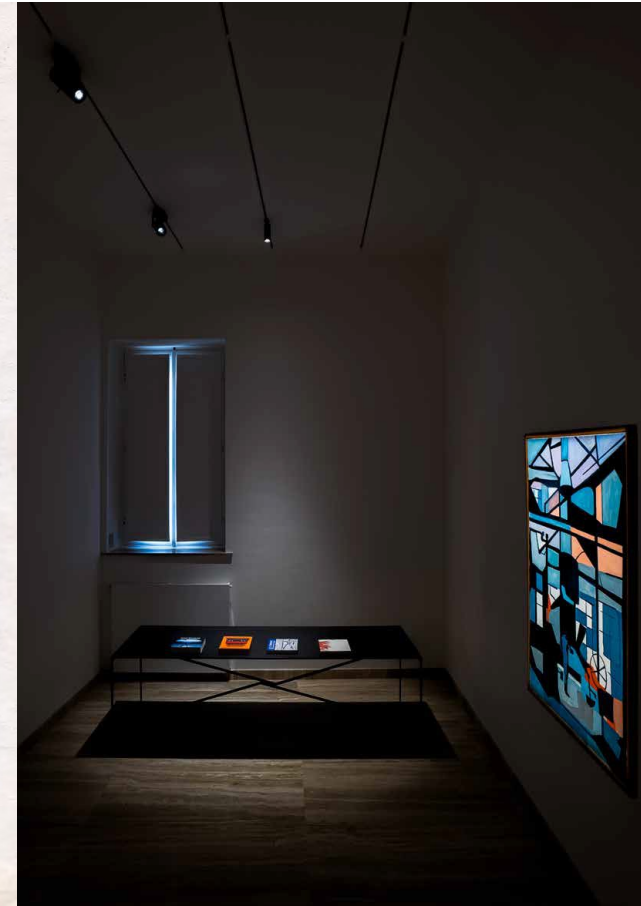
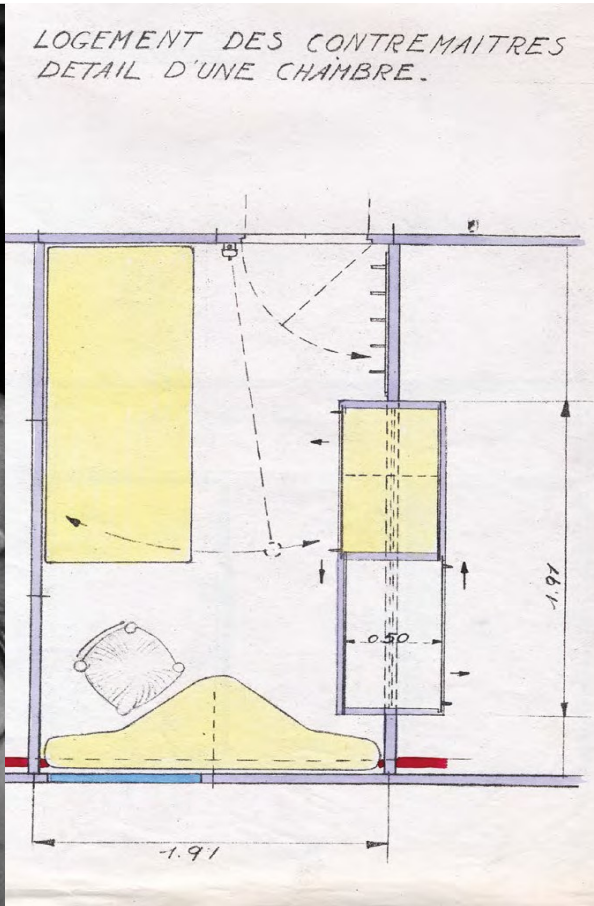

## GET IN TOUCH:

Thomas Götsch  
Business Development DACH

[Thomas.Goetsch@NemoLighting.com](mailto:Thomas.Goetsch@NemoLighting.com)

+39 328 24 888 02

[NEMOLIGHTING.COM](http://NEMOLIGHTING.COM)